

**ALLDAY
& MILLER**



Lansbury Drive, Hayes, UB4 8SW
£520,000

3 1 1



Lansbury Drive, Hayes, UB4 8SW

£520,000

- Three Bedrooms
- Nash Built House
- Through Lounge
- Driveway
- Good Schools Nearby
- Semi-Detached
- Potential To Extend STPP
- Large Rear Garden
- Popular Residential Road
- Easy Reach To An Elizabeth Line Station

Description

A well-presented home offering comfortable and practical living throughout.

The ground floor comprises a spacious reception/dining room and a fitted kitchen. The property has great scope to extend further on the ground floor.

To the first floor, there are three well-proportioned bedrooms and a family bathroom.

Externally, the property benefits from a front driveway providing off-road parking, along with a generous private rear garden mainly laid to lawn.

Situation

Lansbury Drive a popular residential road in North Hayes close to a number of local amenities including Kingshill high street with its variety of local shops, cafes, bakery's, takeaways and coffee shops. A number of highly regarded schools in the local area including Hayes Park primary school, St. Raphaels and Barnhill Community high school. Northolt Underground Station & Hayes and Harlington station within easy reach, its several bus links available and the central/ Elizabeth line giving easy links to Central London and the surrounding area.



Floor Plans

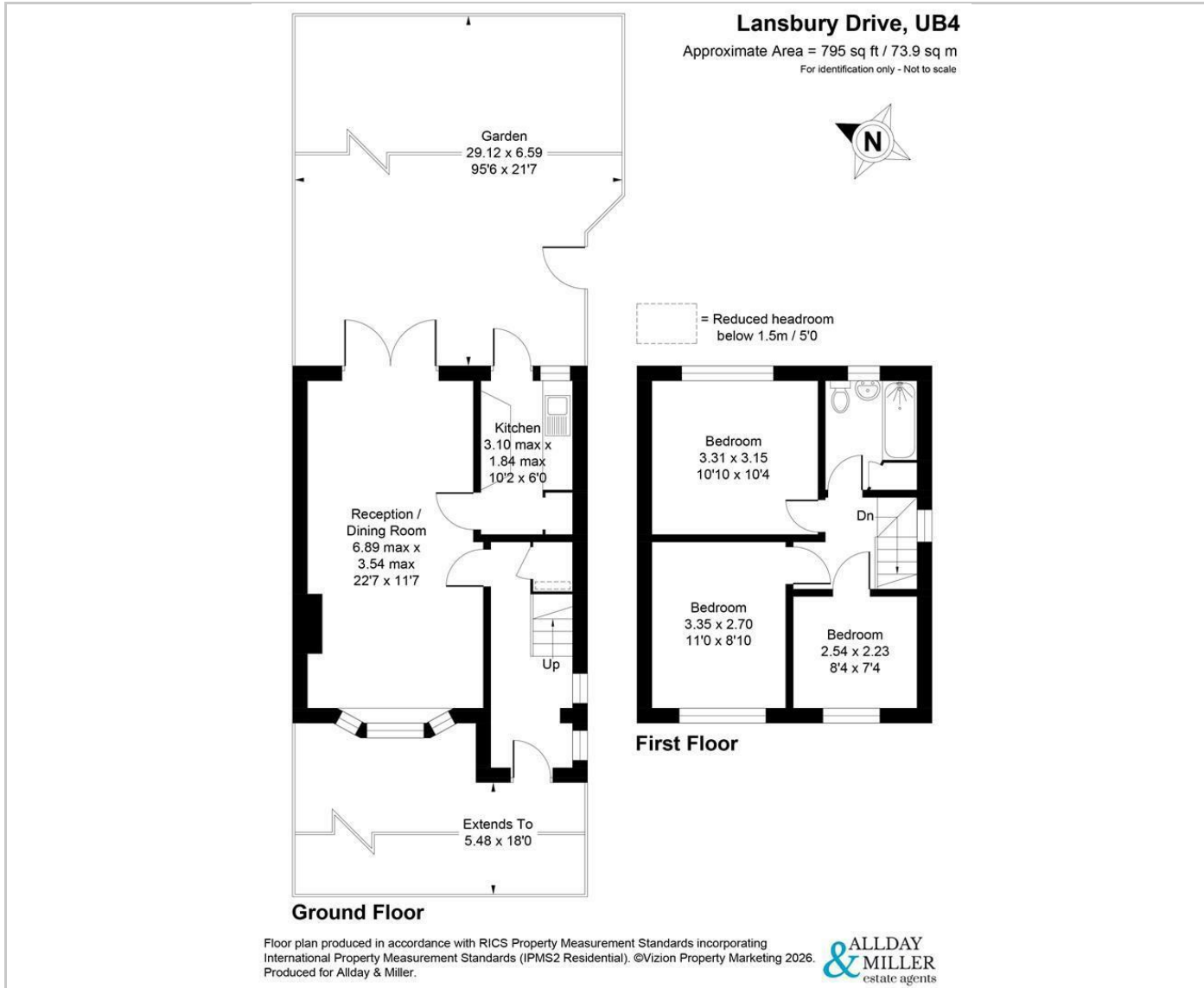

Area Map

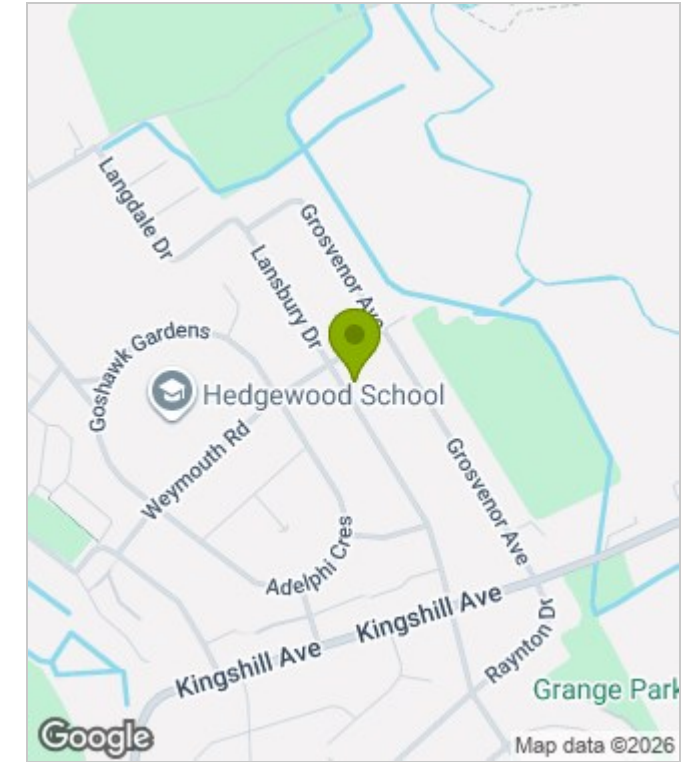

Energy Performance Graph

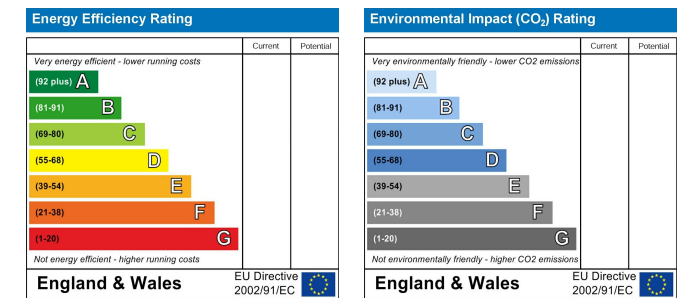

These particulars, whilst believed to be accurate are set out as a general outline only for guidance and do not constitute any part of an offer or contract. Intending purchasers should not rely on them as statements of representation of fact, but must satisfy themselves by inspection or otherwise as to their accuracy. No person in this firm's employment has the authority to make or give any representation or warranty in respect of the property.